

Support the Health Centre Emergency Room Expansion
 Campaign through a personal donation to the
 Mayne Island Health Centre Association.
 TAX RECEIPTS ISSUED FOR DONATIONS OVER \$20



MAYNE ISLAND
 HEALTH CENTRE ASSOCIATION

NAME _____

ADDRESS _____

ENCLOSED
 AMOUNT \$ _____

CHQ # _____

THANK YOU!

100% of ALL DONATIONS GO TOWARD THIS CAPITAL PROJECT

Please mail to Mayne Island Health Centre Association S-1 C-66 Mayne Island, B.C. V0N 2J0



the PLAN

To expand the present
EMERGENCY ROOM wing by
 approximately 350 sq.ft. and thus
 provide space for a
DEDICATED EMERGENCY AREA,
 a separate Treatment/Isolation
 Room and appropriate storage.

WE MUST RAISE \$100,000.00

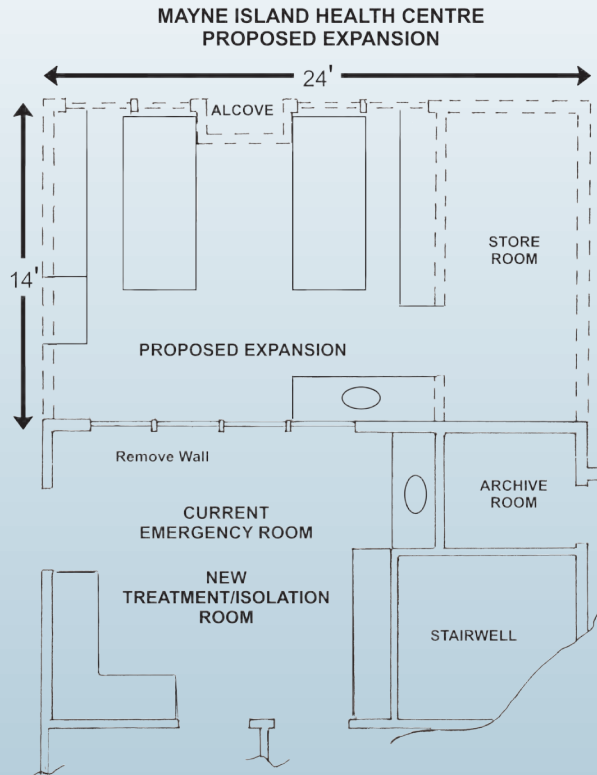

HELP!



YOU CAN HELP

YOU CAN HELP

More Space and
 Improved Critical Care Facilities
 are Urgently Needed

what we HAVE

AN OVERCROWDED EMERGENCY AREA that is NO LONGER FUNCTIONAL

Our current Emergency Room has become a multi-purpose space used for a number of services that are not emergent. This has resulted in the room being crowded with equipment, furniture and supplies which make it difficult to work in and a challenge to clean.



what we NEED

A DEDICATED EMERGENCY AREA

... with SUFFICIENT SPACE
to allow the
DOCTOR/NURSE/PARAMEDICS/
AMBULANCE CREW
to work safely and efficiently
with the necessary equipment
readily accessible

OVERUTILIZED OVERCROWDED DIFFICULT to CLEAN



WITH YOUR FINANCIAL SUPPORT

DESIGNATED AREAS for EMERGENCY TREATMENT

APPROPRIATE UTILIZATION

ADDITIONAL & PROPERLY ENCLOSED STORAGE

what we NEED

A DEDICATED TREATMENT/ISOLATION ROOM

... designed to be used for minor procedures and with a dedicated isolation area to separate infectious patients from those in the waiting room and from patients receiving treatment in other areas. With the advent of antibiotic-resistant bacteria, it is necessary that this area remain uncluttered. It is imperative that emergency treatment and isolation rooms be easily cleaned and disinfected.

All storage space needs to be enclosed.

what we NEED

ADEQUATE STORAGE SPACE

Increased medical personnel means increasing amounts of supplies and equipment, all of which must be stored away from possible sources of contamination by infectious agents, i.e., behind closed doors. Open shelving will need to be upgraded in the Emergency Treatment Area and in the Treatment/Isolation Room.

YOU CAN HELP